

AERIAL VIEW



VICINITY MAP



STREET VIEW

AUNT HONEY'S CANNABIS DISPENSARY  
GREAM ENTERPRISE INC  
TENANT IMPROVEMENT  
1147 & 1149 "B" STREET HAYWARD, CALIFORNIA 94545

| PROJECT INFORMATION   | COMPLIANCE NOTES   |              |      |  |      |  |      |   |      |                         |  |
|---|--|--------------|------|--|------|--|------|---|------|-------------------------|--|
| <p><b>BUSINESS TYPE:</b> RETAIL</p> <p><b># OF STORIES:</b> ONE (1)</p> <p><b>LOT AREA:</b> 17,860 SQ. FT.</p> <p><b>AREA OF TI WORK:</b> 3,578 SQ. FT.</p> <p><b>APN:</b> 427-0011-021-00</p> <p><b>TYPE OF CONSTRUCTION:</b> V-B</p> <p><b>FIRE SPRINKLER:</b> NO</p> <p><b>OCCUPANCY TYPE:</b> "B"</p> <p><b>ZONING AREA:</b> CC-C</p> <p><b>PARCEL:</b></p>   | <p><b>FIRE/ENVIRONMENTAL NOTES:</b></p> <p>1. A SEPARATE PERMIT IS REQUIRED FOR THE FIRE SUPPRESSION SYSTEM. OWNER, CONTRACTOR OR VENDOR TO PROVIDE A DEFERRED SUBMITTAL PACKAGE FOR THE FIRE SUPPRESSION SYSTEM REQUIREMENTS TO THE ALAMEDA COUNTY FIRE DEPARTMENT FOR APPROVAL.</p> <p>2. THE APPLICANT SHALL COMPLY WITH THE PROVISIONS OF PERMITS REQUIRED FROM ANY STATE OR REGIONAL AGENCIES, INCLUDING, BUT NOT LIMITED TO, THE BAY AREA QUALITY MANAGEMENT DISTRICT (BAAQMD), REGIONAL WATER QUALITY BOARD (RWQCB), UNION SANITARY DISTRICT, S (USD) POTW AND THE ALAMEDA COUNTY DEPARTMENT OF ENVIRONMENTAL HEALTH, THE ALAMEDA COUNTY FIRE DEPARTMENT AND THE CITY OF HAYWARD ENVIRONMENTAL SERVICES.</p> <p>3. THE APPLICANT MUST IMMEDIATELY NOTIFY THE ALAMEDA COUNTY FIRE DEPARTMENT AND THE CITY OF HAYWARD ENVIRONMENTAL SERVICES HAZARDOUS MATERIALS UNIT OF ANY UNDERGROUND PIPES, TANKS OR STRUCTURES; ANY SUSPECTED OR ACTUAL CONTAMINATED SOILS; OR OTHER ENVIRONMENTAL ANOMALIES ENCOUNTERED DURING SITE DEVELOPMENT ACTIVITIES. ANY CONFIRMED ENVIRONMENTAL LIABILITIES WILL NEED TO BE REMEDIED PRIOR TO PROCEEDING WITH SITE DEVELOPMENT.</p> <p>4. THE APPLICANT SHALL COMPLY WITH THE CURRENT CALIFORNIA BUILDING CODES, LOCAL ORDINANCES AND ALL APPLICABLE STATE, COUNTY AND CITY ENFORCEMENT/COMPLIANCE. ALL WORK AND INSTALLATION TO PERFORM MUST BE DONE IN ACCORDANCE TO THE CURRENT CODE SET FORTH BY THE STATE OF CALIFORNIA. CONTRACTOR SHALL BE RESPONSIBLE ON ALL BUILDING PROCESS, IMPROVEMENTS AND CHANGES TO BE DONE WITHIN THE SCOPE OF WORK DEPICTED OR NOT SPECIFIED IN THIS PERMIT DRAWINGS.</p> <p>5. BUILDING AND TENANT SPACE HAS NO FIRE SPRINKLERS AND FIRE ALARMS IN PLACE AND NO NEW INSTALLATION OF SUCH IS PART OF THIS SCOPE OF WORK. CONTRACTOR SHALL PROVIDE A SEPARATE DEFERRED SUBMITTAL FOR THE KITCHEN HOOD FIRE SUPPRESSION SYSTEM ONLY FOR PERMIT APPROVAL.</p> |              |      |  |      |  |      |   |      |                         |  |
| DESIGNER INFORMATION  |  |              |      |  |      |  |      |   |      |                         |  |
| <p><b>dba RVL DESIGN SERVICES</b> CA. LICENSE # 34187</p> <p><b>DESIGNER:</b> VICTOR LINO<br/>PH. 510.828.6810<br/>EMAIL: victor_derudeign@outlook.com</p> <p><b>CONSULTANT:</b> HENRY ZUO, P.E.<br/>LIC.# M31960</p>   |  |              |      |  |      |  |      |   |      |                         |  |
| CONSTRUCTION NOTES  |  |              |      |  |      |  |      |   |      |                         |  |
| <p>1. CONSTRUCTION ACTIVITIES SHALL BE LIMITED TO THE FOLLOWING HOURS OF OPERATION PER CITY OF HAYWARD ORDINANCES :<br/>7 a.m. TO 7 p.m. MONDAY THROUGH FRIDAY<br/>9 a.m. TO 6 p.m. SATURDAY AND SUNDAY</p> <p>2. FIRE DEPARTMENT ACCESS MUST BE PROVIDED AND MAINTAINED SERVICEABLE.</p> <p>3. PROVIDE AN EMERGENCY TELEPHONE ON THE JOB SITE.</p>   |  |              |      |  |      |  |      |   |      |                         |  |
| PROJECT SCOPE OF WORK   |  |              |      |  |      |  |      |   |      |                         |  |
| <p>THE SCOPE OF WORK UNDER THIS APPLICATION INCLUDES THE NECESSARY TENANT IMPROVEMENT TO ACCOMMODATE A NEW RETAIL/DISPENSARY AND DELIVERY SERVICE FACILITY. THE FOLLOWING WORK INCLUDES: NEW NON-BEARING PARTITION WALLS TO CREATE A NEW UNISEX RESTROOM AND MANAGERS OFFICE. A NEW MECHANICAL HVAC ROOFTOP UNIT ARE BEING PROPOSED WITH NEW AIR DISTRIBUTION AND EXHAUST SYSTEM. IN ADDITION, BATHROOM FIXTURES WILL BE INSTALLED WITH PLUMBING LINES AND GENERAL LIGHTING, POWER OUTLETS/RECEPTACLES TO BE INSTALLED. NO UPGRADE TO THE EXISTING ELECTRICAL SERVICE AND GAS. NO ALTERATIONS AND/OR MODIFICATIONS TO THE EXISTING BUILDING SHELL AND EXTERIOR WALLS ARE PROPOSED UNDER THIS APPLICATION.</p>   |  |              |      |  |      |  |      |   |      |                         |  |
| GENERAL NOTES   |  |              |      |  |      |  |      |   |      |                         |  |
| <p>1. BEFORE STARTING ANY WORK, THE CONTRACTOR SHALL VERIFY THE EXISTING SITE CONDITIONS AND ACCURACY OF THE SCOPE OF WORK AND SHALL INDICATE TO THE ARCHITECT ANY DISCREPANCIES THAT MAY BE DISCOVERED IN A TIMELY MANNER.</p> <p>2. ALL WALKWAYS FROM ACCESSIBLE PARKING TO THE ACCESSIBLE ENTRANCES OF THE BUILDING SHALL BE LEVEL WITH MAXIMUM SLOPE NOT TO EXCEED 1:20. CROSS WALKS ARE 2% MAXIMUM SLOPE.</p> <p>3. THE CONTRACTOR SHALL BE RESPONSIBLE FOR OBTAINING ALL APPLICABLE PERMITS AND FURNISHING THE OWNER WITH A COPY OF ALL PERMITS AND FINAL ACCEPTANCES GRANTED BY THE UTILITY COMPANIES AND REGULATORY AGENCIES INVOLVED.</p> <p>4. THE CONTRACTOR SHALL COMPLY WITH THE RULES AND REGULATIONS OF THE CITY OF HAYWARD REGARDING SITE ACCESS, DELIVERIES, HANDLING OF MATERIALS, DEBRIS, ETC.</p> <p>5. THE CONTRACTOR SHALL NOTIFY THE OWNER IMMEDIATELY UPON DISCOVERING ANY ASBESTOS AT THE JOBSITE IN ORDER FOR THE OWNER TO IMMEDIATELY MAKE ARRANGEMENT FOR PROPER REMOVAL BY A LICENSED ASBESTOS REMOVAL CONTRACTOR.</p> <p>6. DO NOT DISTURB THE ADJACENT OCCUPIED AREAS DURING CONSTRUCTION. ALWAYS KEEP PATHWAYS CLEAR AND CLEAN.</p> <p>7. ALL DIMENSIONS ARE TO BE WITHIN THE MARGIN OF ERROR OF 1/2" ALONG FULL HEIGHT AND ALONG FULL WIDTH OF WALLS.</p> <p>8. PROVIDE ADEQUATE WALL BACKING TO SUPPORT THE RELATIVE WEIGHT OF ALL WALL MOUNTED ITEMS AND FIXTURES.</p> |  |              |      |  |      |  |      |   |      |                         |  |
| DRAWING INDEX   |  |              |      |  |      |  |      |   |      |                         |  |
| <table><tr><th>SHEET #:</th><th>SHEET TITLE:</th></tr><tr><td>A1.0</td><td>SITE PHOTO, VICINITY MAP, LEGENDS &amp; GEN. NOTES</td></tr><tr><td>A2.0</td><td>SITE DEVELOPMENT PLAN, PARKING &amp; UTILITIES</td></tr><tr><td>A2.1</td><td>PROPOSED FLOOR PLAN, CCTV &amp; LIGHTING PLAN</td></tr><tr><td>A2.2</td><td>BUILDING ELEVATION PLAN</td></tr></table>  | SHEET #:   | SHEET TITLE: | A1.0 | SITE PHOTO, VICINITY MAP, LEGENDS & GEN. NOTES | A2.0 | SITE DEVELOPMENT PLAN, PARKING & UTILITIES | A2.1 | PROPOSED FLOOR PLAN, CCTV & LIGHTING PLAN | A2.2 | BUILDING ELEVATION PLAN |  |
| SHEET #:  | SHEET TITLE:   |              |      |  |      |  |      |   |      |                         |  |
| A1.0  | SITE PHOTO, VICINITY MAP, LEGENDS & GEN. NOTES   |              |      |  |      |  |      |   |      |                         |  |
| A2.0  | SITE DEVELOPMENT PLAN, PARKING & UTILITIES   |              |      |  |      |  |      |   |      |                         |  |
| A2.1  | PROPOSED FLOOR PLAN, CCTV & LIGHTING PLAN  |              |      |  |      |  |      |   |      |                         |  |
| A2.2  | BUILDING ELEVATION PLAN  |              |      |  |      |  |      |   |      |                         |  |

RVL DESIGN SERVICES

CA License # 38147

SUSTAINABLE

DESIGN

CONCEPTS

AND

SOLUTIONS

MECHANICAL

ELECTRICAL

PLUMBING

Tel. 810.828.6810  
Email: victor\_derudeign@outlook.com  
Visit us @ www.rvl-design.com

SEALS

REGISTERED PROFESSIONAL ENGINEER

HENRY PING ZUO

No. M31960

Exp. 12-31-20

12/11/2019

SHEET TITLE:

AUNT HONEY'S CANNABIS DISPENSARY

GREAM ENTERPRISE INC

1147 "B" STREET, HAYWARD CALIFORNIA 945401

APN #: 427-0011-021-00

Tenant Improvement For:

OWNER INFORMATION

Gregory S. Varr  
TEL: (408) 252-0888  
EMAIL: gsvarr@vafco.com

CONTRACTOR

BANKS CONSTRUCTION  
GENERAL CONTRACTORS  
TEL: (910) 821-6889

PROJECT NO:

V.L. 2018-001

DATE OF PLANS

November 05, 2018

ISSUE FOR PERMIT

MAY 08, 2019

REVISIONS

ISSUE FOR PERMIT  
MAY 08, 2019

DRAWN BY:

VL

CHECKED BY:

HZ  
ML

DATE

NOVEMBER , 2018

SCALE

1/4" = 1'-0"

SHEET NAME:

ARCHITECTURAL

SHEET TITLE:

SITE PLAN,  
VICINITY MAP,  
BUILDING LEGEND  
AND  
GENERAL NOTES

SHEET NUMBER

A1.0



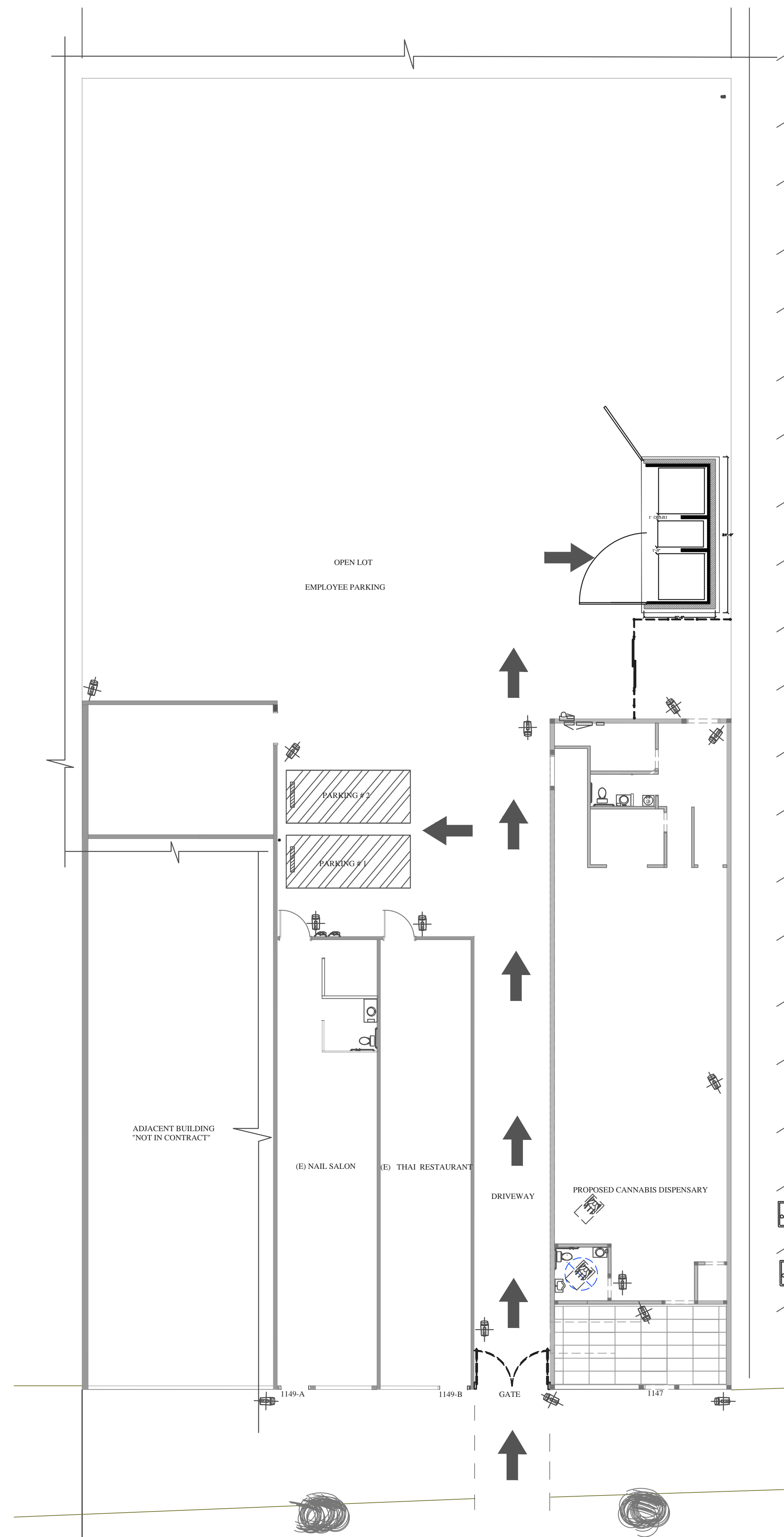

## PROPOSED SITE PLAN

|                 |
|-----------------|
| 1               |
| $3/32" = 1'-0"$ |

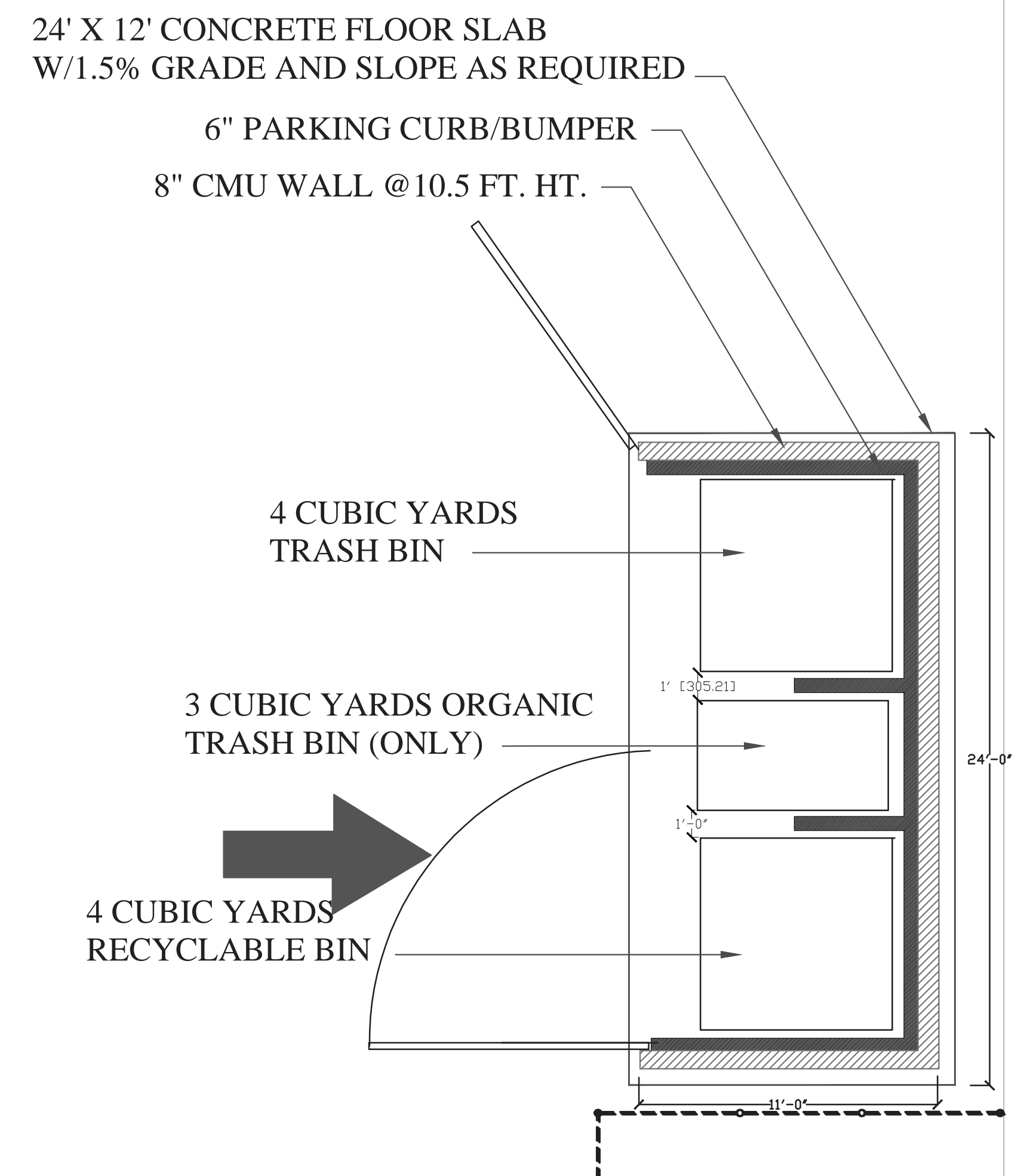

## ENLARGED SCALE- TRASH BIN ENCLOSURE

|              |
|--------------|
| 3            |
| 1/4" = 1'-0" |

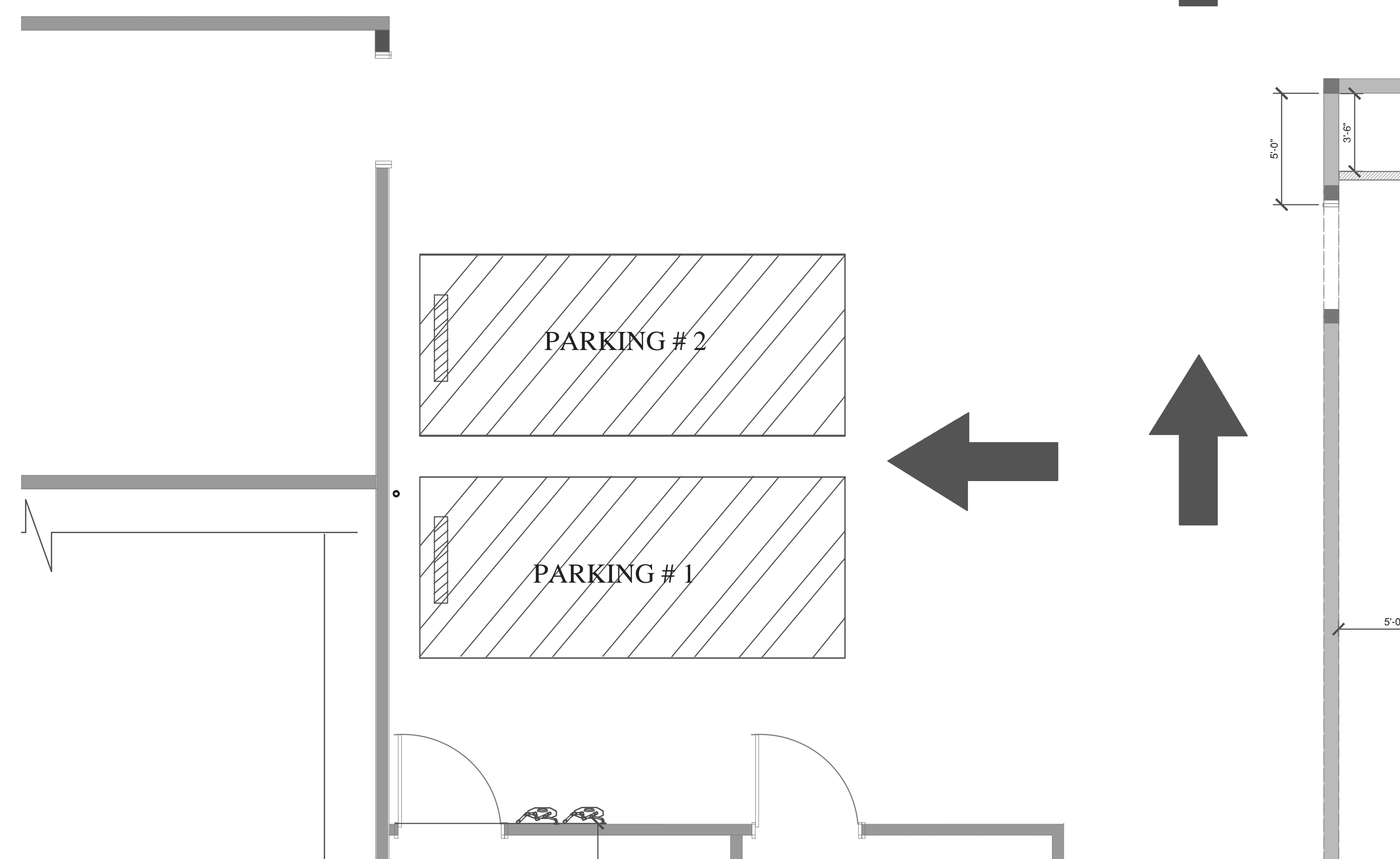

## ENLARGED SCALE- PROPOSED PARKING STALLS

|              |
|--------------|
| 2            |
| 1/4" = 1'-0" |

Tenant Improvement For:

**AUNT HONEY'S CANNABIS DISPENSARY**  
**GREAM ENTERPRISE INC**  
 1147 'B' STREET, HAYWARD, CALIFORNIA 945401  
 APN #: 327-0011-0211-00)

OWNER INFORMATION

☐ **Gregory S. Varr**  
TEL. (408) 252-8888  
EMAIL. [gsarrn@yahoo.com](mailto:gsarrn@yahoo.com)

**CONTRACTOR**  
BANKS CONSTRUCTION  
GENERAL CONTRACTOR  
TEL (510) 921-9899

PROJECT NO:  
15-0310-001

DATE OF PLANS

☒ November 05, 2018

ISSUE FOR PERMIT  
MAY 06, 2010

© 2017 by RVL Design  
MV not a trade name. RVL Design

**REVISIONS**

ISSUE FOR PERMIT  
MAY 08, 2019

☐ ☐ ☐

4

**DRAWN BY:**  
☒ VL  
☐

✓  
CHECKED BY:  
✓ HZ

☐ ML

DATE \_\_\_\_\_

**SCALE**  $1/4" = 1'-0"$

**SHEET NAME:**  
**ARCHITECTU**

**SHEET TITLE:**

## SITE PLAN,

## PARKING AND TRASH

ENCLOSURE



SHEET NUMBER: 1 2 3

A2.0





